



Kömmerling®

TODAY FOR TOMORROW



KömaStyle® Installation Guidelines



1. REMOVAL

During a renovation, first remove the existing fittings by shutting off the water and switching off the fuses.

2. CHECKING THE SURFACE



The surface to which you would like to attach the KömaStyle sheet must be solid, capable of load bearing, dry, dust-free and clean. Variations in the evenness of the surface must be properly rectified at the beginning or taken into consideration accordingly when applying adhesive.

An adhesive primer coating must be applied to absorbent surfaces before bonding the sheets. For best results, use the LUGATO universal adhesive primer or one from a similar manufacturer.

Surfaces in areas that are exposed to moisture, e.g. baths and showers, must always be properly sealed with liquid sealants in accordance with DIN 18534, e.g. from LUGATO or sheet sealing systems, before adhering our KömaStyle sheets. The manufacturers' manufacturing instructions must be observed while doing so.

3. TAKING DIMENSIONS

Determine all the necessary dimensions for cutting the sheets.

TIP: The professional uses a laser level to level the horizontal and vertical elevation in metres at the planned sheet joint and measures the measurement points from there.

Include a border of at least 5 mm on the left and right and above the sheet (material expansion). You should also carefully consider the visual division of the sheets in advance and plot it accordingly. While doing so, take the repeat and the colour laminate division of the sheets into consideration.

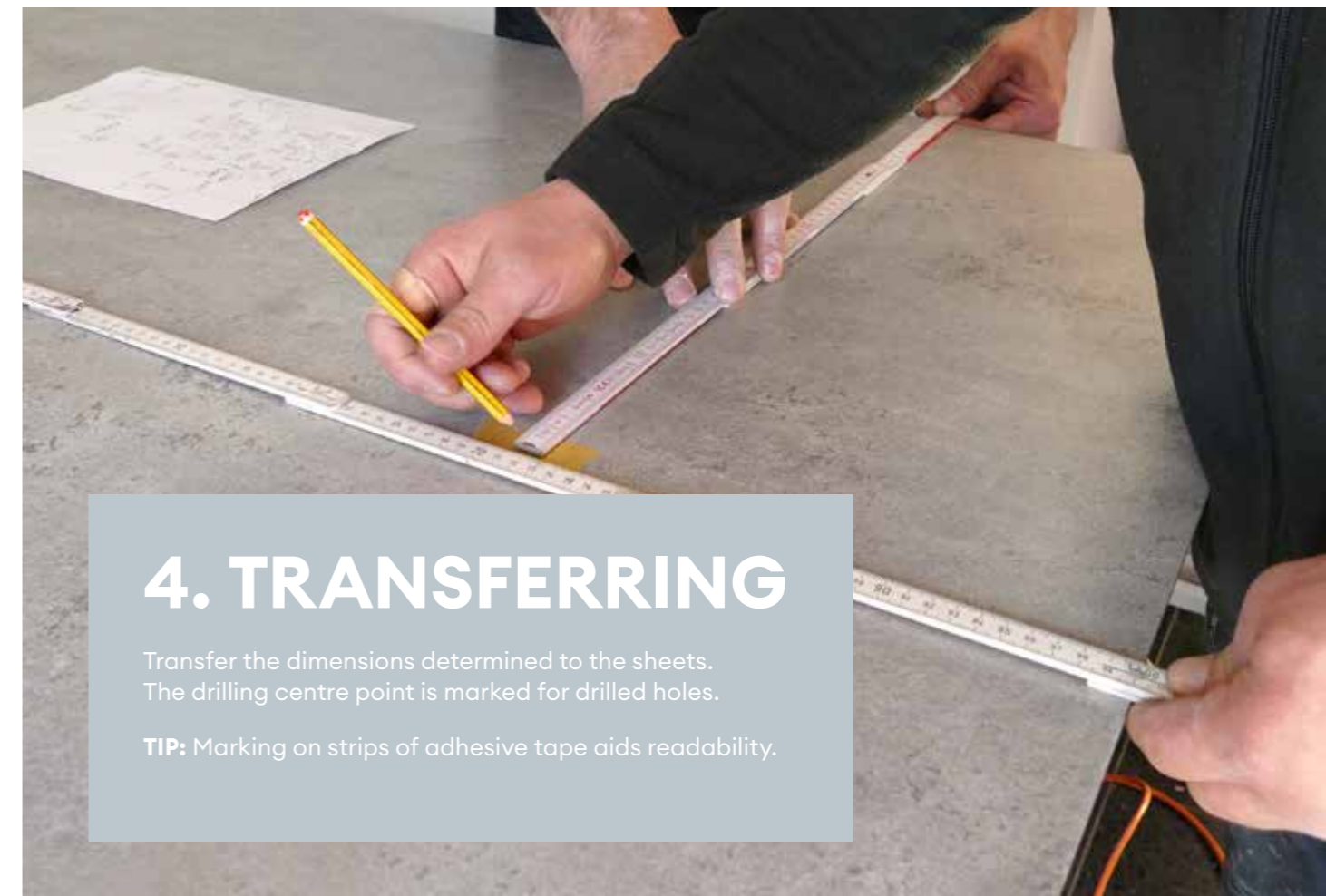

4. TRANSFERRING

Transfer the dimensions determined to the sheets. The drilling centre point is marked for drilled holes.

TIP: Marking on strips of adhesive tape aids readability.



TIP: Predrill cut-outs in the corners and saw out with a fine-toothed jigsaw.

5. TRIMMING

All woodworking and metalworking machines can generally be used (commercial handheld circular saws or jigsaws) to produce a sharp joint without any cracks.

With jigsaws, use saw blades for wood or plastic and, with circular saws, use a trapezoidal flat-toothed saw blade.

For best results in terms of the cleanliness of the sawn edge, ensure that you use a guide rail or work on the back of the sheet.

When cutting decorative panels, the cutting marks must be observed. Especially when working on butt joints or when displaying in a 90° corner. This mainly applies to the following decors: Teak Wall II and Klinkerstein.

If the KömaStyle sheets are not processed together with the appropriate end and connecting profiles, the board must be trimmed 5 mm on the long sides so that no gaps can form in the butt joint.

6. DRILLING

The best way to drill holes for fittings is to use a fine-toothed hole saw with an appropriate diameter. When making adjustments, you can also use commercial hand power drills or cordless screwdrivers, with the standard drill bits for metal and plastic. For larger holes, such as for fittings, water supply lines or drainage connections, use hole saws.

Always follow our Kömmerling sheet manufacturing instructions for sawing and drilling information.



7. CHECKING AND ADAPTING

Before being fixed in place, the sheet on the wall is checked to ensure a precision fit and adapted if necessary.

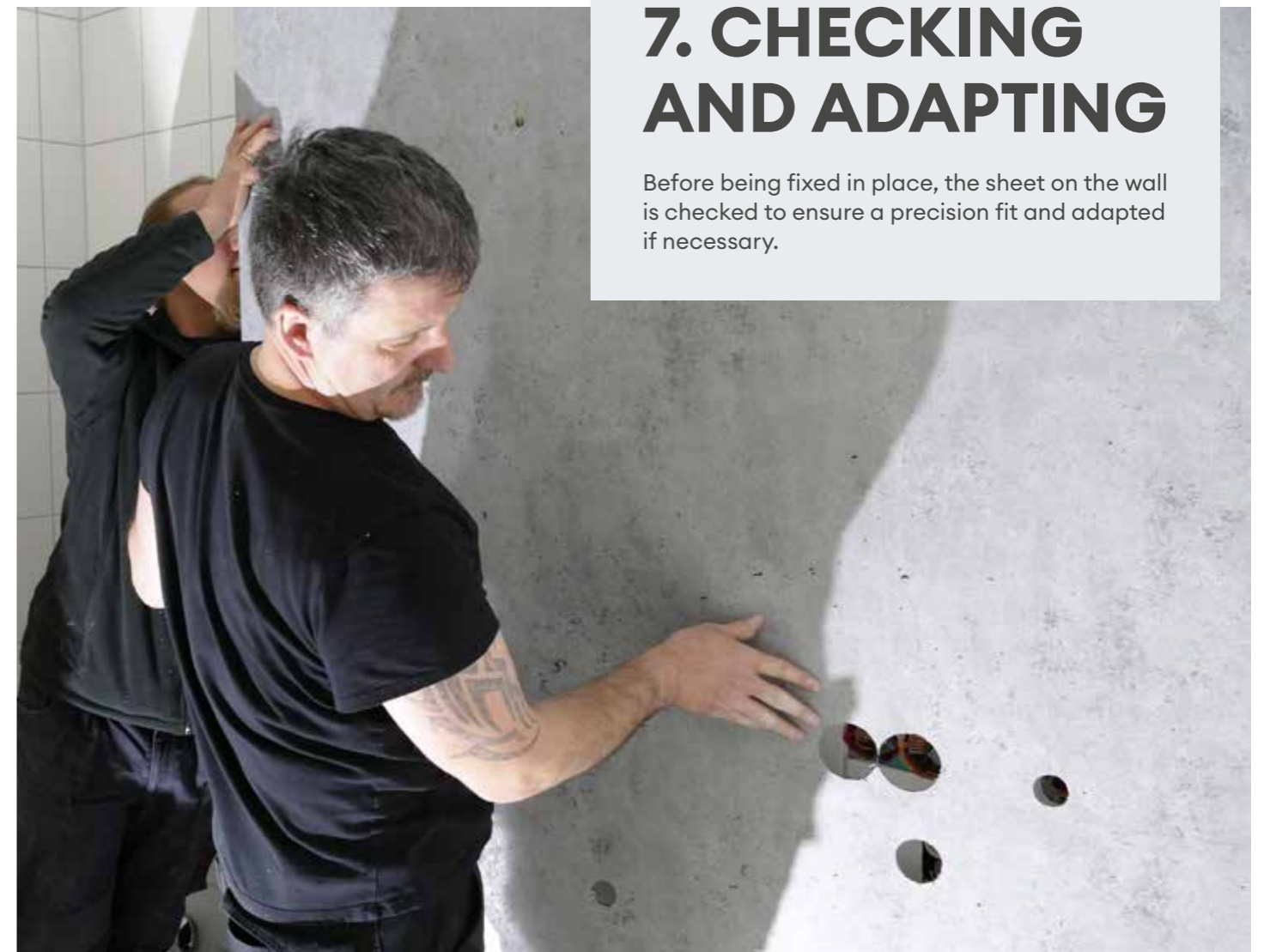

8. APPLYING ADHESIVE



Depending on the product, pull the protective film off the back of the colour laminate sheet. Clean the back of the sheet with a cleaning agent (Kleiberit cleaning agent 820.0, toluene-free) and wait until it is fully dry. A similar cleaning agent, which is compatible with PVC surfaces, can also be used here subject to approval from the cleaning agent manufacturer. Allow the cleaning agent used to dry sufficiently.

For best results, use the Kleiberit 584.0 adhesive. A similar mounting glue, which is compatible with absorbent and non-absorbent surfaces, can also be used here subject to approval from the adhesive manufacturer. Please use a sufficient quantity of adhesive. We recommend 1-1.5 cartridges per m² (300 ml) or at least one cartridge.

Adhesive

Apply the adhesive across the entire surface of the wall using a toothed spatula or alternatively apply beads of adhesive to the cleaned back of the colour laminate sheet. Then apply the adhesive in vertical lines to the back of the sheet. Ideally, it should be applied over the entire surface with a B15 toothed spatula. Please follow the manufacturing instructions relating to the specific mounting glue you are using.



9. INSTALLING

First of all, the sheet must be attached in the required position at the bottom. It is important to press down gently on the sheet from bottom to top once it has been correctly positioned. You can now correct this if necessary. If you require end beads, these can be attached as an option.

Then, firmly press down on the KömaStyle sheet over its entire surface. This ensures that the adhesive is evenly distributed and the KömaStyle sheet will remain in the required position. Any excess adhesive must be removed immediately.



Sheet joint



Rapport Installation

The design offset and repeat must be carefully observed for decors that have a striking structure and a pattern or motif that is repeated in itself.

Decors that have a continuous design or motif must be bonded with consideration for the pattern offset and repeat for a seamless overall appearance. When gluing the subsequent decor panel, the smooth transition of the pattern between the two decors must be ensured.



10. FITTING SHEETS

Trim, check and adapt the next sheet. There are various options for connecting the sheets together and fitting them.

Option 1

You bond the sheets with connecting profiles: In the connecting profile (H profile), apply silicone or MS polymer adhesive before you push the sheets into the profile.

Option 2

Before final placement, apply silicone or MS polymer adhesive to the joint.

Option 3

Bond with tongue and groove.

Trim the sheets with a handheld circular saw, ideally with a guide rail. Using a router, route a 2 mm groove (at least 10 mm deep) in the outer edge of the sheet. Always use the colour laminate side of the sheet as the installation side. Join the sheets to a 2 mm thick KömaDur strip (15 mm wide) using silicone or MS polymer adhesive. This is used to fix the joint in place and also to fully seal the joint. The tools from FESTOOL are ideal for this purpose.



11. ATTACH THE SHEETS

Sheets can be fitted easily one after the other using a vacuum handling device.

Note: The vacuum handling device does not work with highly textured colour laminates.



12. HOSING OUT OPENINGS WITH SILICONE AND INSTALLING FITTINGS

Observe the drying time: You can fit the shower slide bar and similar parts after 24 hours.

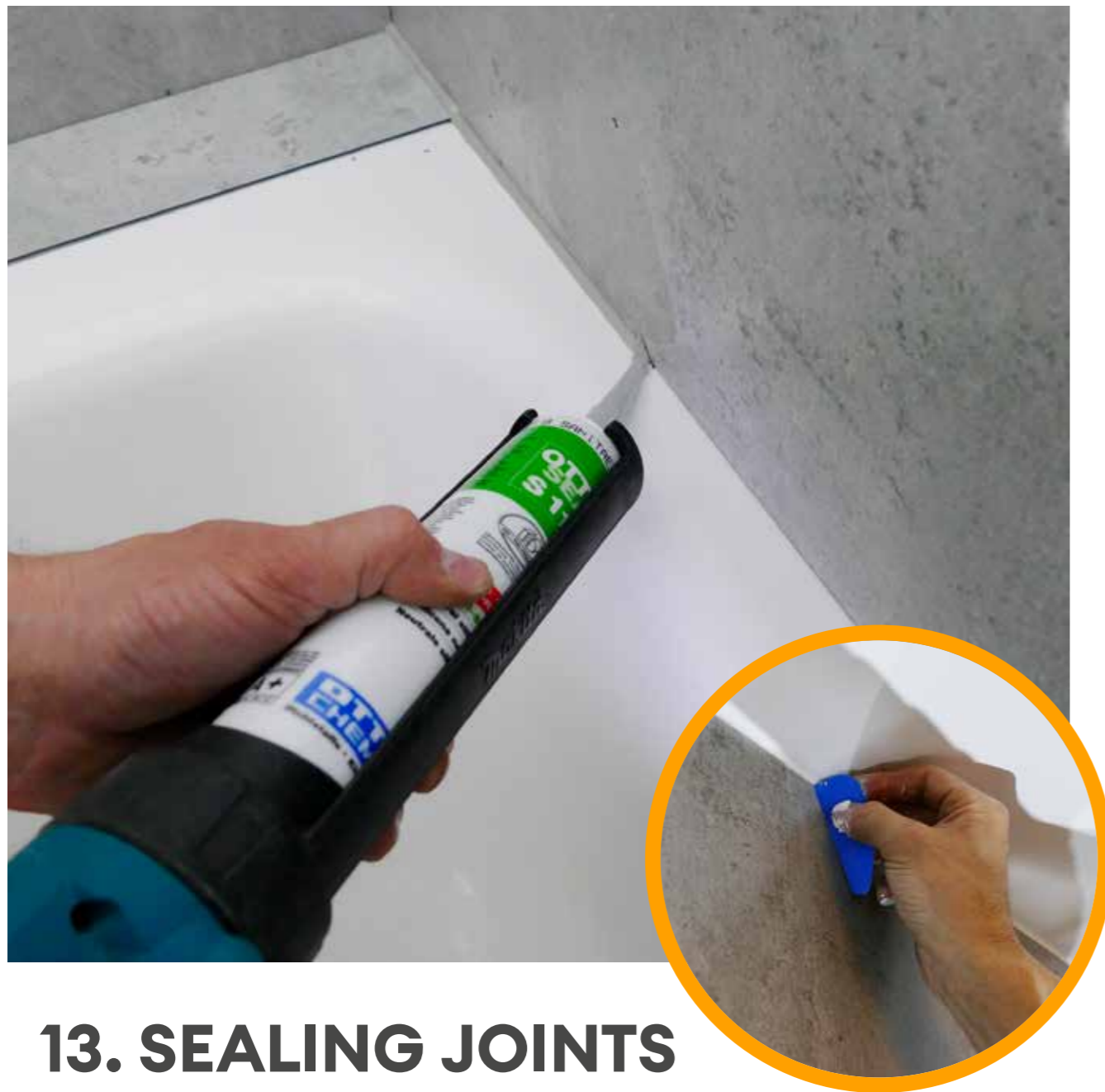

13. SEALING JOINTS WITH SILICONE AND REMOVING THE SILICONE

Remove the protective film by pulling it off the colour laminate surface.

The KömaStyle sheet is ready to be sealed and joined after just 48 hours. While doing so, ensure that the PVC sheet is clean and well-sealed at all open edges, cut surfaces and drill surfaces to achieve the longest possible service life.

A sealed joint is always a maintenance joint, which is why the joint material has to be replaced regularly. You can use a commercial, neutral cross-linking silicone for this (e.g. Kleiberit 594N).

If no connecting profiles are used, or if it is not possible to use these, a PE joint filling rope must be inserted into the joint before it is joined using silicone.

INSTALLATION ANCILLARIES



Sheet joint

Sheet joint track

- > Thickness: 1 mm
- > Metal strip, galvanised, format: 3000 x 100 mm
- > For flush installation of butt-joined sheets
- > Glue the metal strip to the sheet joint in the centre using silicone or MS polymer adhesive (alternatively duct tape)
- > If necessary, position the magnetic punch and press the sheets down flush until hardened

PROFILES

Profiles for KömaCel sheets (8 mm)



H profile



U profile



Corner profile

Profiles for aluminium composite sheets (3 mm)



External corner profile 90°



Internal corner profile 90°



Connecting profile



End profile

14. FINAL STEPS

The silicone is cured after just 24 hours and can withstand moisture. As soon as the joint material has hardened (crosslinked = fixed) – please follow the manufacturing instructions provided by the manufacturer – your new bath is ready to use and you can enjoy the new ambiance.





GENERAL INSTRUCTIONS

Storing and handling the colour laminate sheets

The sheets must be stored in a horizontal position in dry rooms, protected against exposure to wind and weather, at a temperature between 15 and 30 °C.

Ideally, the sheets should also be transported in a horizontal position. If the sheets are transported in a vertical position, they must be held in place with a ratchet strap, which prevents deflection. When positioned outdoors or in front of glass facades, the sheets must be protected against direct solar irradiation with a cover (e.g. cardboard). This stops the sheets from overheating and prevents them from warping easily.

Improvements in the case of incorrect drilling work, modifications or damage

The following material can be used as filler for incorrect drilling work or for deep scratches:

Heinrich König & Co.KG, An der Rosenhelle 5, 61138 Niederdorfelden, Germany
www.heinrich-koenig.de

Repair set medium 613 343 hard wax PLUS.

If you only need to retouch the colour, the following paint set can be used:

Heinrich König & Co.KG, An der Rosenhelle 5, 61138 Niederdorfelden, Germany
www.heinrich-koenig.de

Complete wood retouch package 250 000.

Removal and recycling

If you choose a new design or move out of a rented property, your KömaStyle sheet can be removed by a professional. The homogeneous product structure of KömaCel based on PVC means that the PVC-U sheet is also fully recyclable. The products based on KömaAlu are also easy to recycle.

CLEANING AND CARE SERVICE

During the development of the surfaces for **KömaStyle** particular attention was given to achieving a high degree of practicality. In addition to a long service life, they offer excellent cleaning properties for low maintenance. Adhering dirt can be easily and thoroughly removed without great use of force and largely without the use of chemical agents.

In order to maintain the beauty and intrinsic value of your **KömaStyle** surfaces, the following **cleaning and care advice** should be adhered to:

In general, it will suffice to clean the surface regularly with a damp, soft and lint-free or non-abrasive cloth. If necessary, a mild household cleaner (washing-up liquid) can be added to the cleaning water.

Heavier soiling and possible stains, particularly from highly coloured substances and liquids (like mustard, coffee, tea, red wine, etc. for example) should be washed off with water as quickly **as possible**, possibly with the addition of a **proprietary, non-abrasive** household cleaner. **Stains must not be allowed to dry.**

Stubborn stain residues, particularly spots of grease and grease deposits from **vegetable oils or body and suntan lotions (fingerprints)** can be brushed off using a warm 30% soft soap solution and a **soft** dish washing or hand washing brush.

Surface stains caused by limescale deposits that cannot be cleaned off by the methods described above can be treated with **proprietary bathroom cleaning agents**, limescale remover or de-scaling agents, e.g. for coffee machines or electric kettles. **Always observe the application and dosage recommendations of the respective manufacturer when using such agents.**

It should also be noted that such agents should **not be allowed to dry out for an extended period of time** and must be rinsed off with clear water after the recommended exposure time. Tried and trusted household agents such as vinegar essence

must **not be used in concentrated or undiluted form**. We recommend dilution with water at a **ratio of 1 part of vinegar essence – 10 parts of water**. Limescale stains and limescale deposits can be removed easily with this. Even if the solution is allowed to dry inadvertently, it will leave no trace on the surface.

When using proprietary household cleaning agents, be sure not to use **any undiluted or concentrated cleaning agents that are strongly coloured** as these dyes can also leave deposits.

Steam cleaners, pressure washers, eraser sponges and sharp-edged objects or abrasive cleaning aids such as steel wool and the likes are not suitable for cleaning vinyl surfaces. These are also not resistant to organic solvents such as thinners, nail varnish remover, plastic cleaners containing organic solvents like acetone and/or acetates or undiluted spirits (spirits must be diluted 1:2 with water!) and hair dyes or bleaches, stamping ink and black ballpoint pen paste ink. Deposits must be removed immediately.

In order to prevent drops and excess moisture from forming, it is recommended that excess water be removed from all surfaces using a soft cloth or a shower squeegee and to keep these surfaces dry. This will keep your decorative wall surfaces hygienically clean and extend the service life of your panels at the same time.

Important:

Always adhere to the concentrations recommended by the respective manufacturer of any cleaning agents.

Plastic cleaners / special cleaners should always be initially tested for compatibility on an inconspicuous place.

Our information provides suggestions for possible applications. It was compiled on the basis of practical experience. It does not claim to be complete and errors and emissions are excepted.

#KömmerlingForTomorrow

profine GmbH
Kömmerling

Zweibrücker Straße 200
66954 Pirmasens
Germany
Tel. +49 6331 56-0
E-Mail: info@koemmerling.com

www.koemmerling.com

